

## Q035 WORKLUX

### Utility Work Light

## PRODUCT OVERVIEW

The WorkLux LED Work Light is a lightweight utility light designed to deliver over 1000-lumens where it's needed most. Ideal for garages and workshops, its compact 2-foot design provides a focused 120-degree viewing angle. Equipped with a power cord and integrated rotary switch, the WorkLux also includes optional hook and magnet mounts for ease of use and secure attachment to various surfaces.



Product	Q035	
General	Lumen Output	1064
	Efficacy	105 lm/w
	Beam Angle (is this something we should include?)	120° FWHM
Electrical	Input Voltage	120 Vac
	Frequency	60 Hz
	Input Power	10.1W
Environment	Operating Temp	-40 to 80° C
	Storage Temp	-40 to 125° C
Mechanical	Mounting	Optional: Magnet, Hook, and Pipe Hook
	Dimension	1" Diameter, 26.25" length
	Weight	8.3 oz (236 g)
	Cable	6', 18 AWG, NEMA 1-15P, Rotatory Switch
Regulatory	Compliance	RoHS 3 (EU 2015/863)
	Warranty	<a href="#">LEDdynamics Warranty</a>

\* All specifications subject to change without prior notification.



# Q035 WORKLUX

## Utility Work Light

### Ordering Information

Example: Q035-850

PRODUCT ID	-	CRI	CCT
<b>Q035</b>			<b>2700K</b>
		<b>70+</b>	<b>3000K</b>
		<b>80+</b>	<b>4000K</b>
		<b>90+</b>	<b>5000K</b>
			<b>5700K</b>
			<b>6500K</b>

### Accessories

PART NUMBER	-	DESCRIPTION
<b>Q035-HOOK</b>		Hook Attachment
<b>Q035-MAGNET</b>		Magnet Attachment
<b>Q035-PIPE</b>		1" Pipe Hook Attachment

### Mechanical

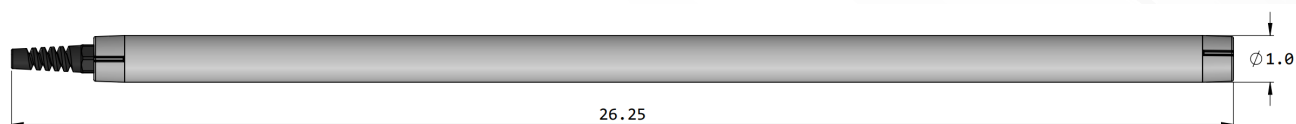

Figure 1. Q035-xxxx

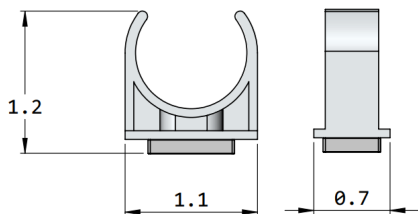

Figure 2. Q035-MAGNET

Dimensions in inches

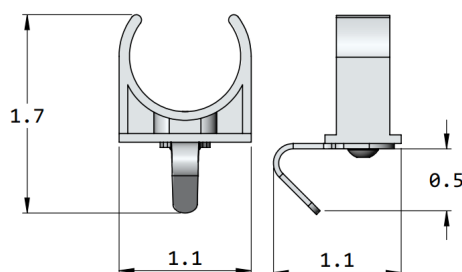

Figure 3. Q035-HOOK

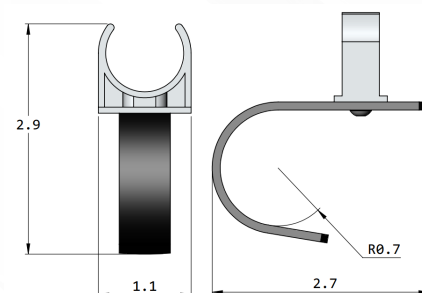

Figure 4. Q035-PIPE